

EXPRESS Yorkshire



Express Package \$5,946

Base price of the home in the selected community, plus Express Package price, plus any applicable lot premium on the selected homesite, equals total sales price.

EXPRESS HOMES are an alternative to traditional build-to-suit new homes. These selected floorplans are available on any Ball Homes homesite in Lexington* Ball Homes communities where the floorplan is already offered and determined to be an appropriate fit.

The Express package is a pre-selected combination of our most popular upgrades and product selections, ready to build and close in only 90 days**. **No selections or option changes are made by the homebuyer.** Ball Homes has construction plans ready and waiting for each Express Home floorplan, with the amenity and color selections made, from the first foundation block to the last ceramic tile.

When a contract is accepted on a Express Home, permit applications are expedited, and plans are rushed to the suppliers, tradespeople, and job superintendent, so that construction can begin immediately, and the new home is completed in only 90 days.

*Not available in other locations due to extended start-up times.

**The 90-day build time offered assumes a slab foundation home. However, basement homes are also offered on suitable lots, with an extra 30 days of build time required. All contracts for Express Homes are contingent on the builder's ability to install the foundation within two weeks of the contract acceptance, as subject to weather constraints.

See reverse for option and finish details.

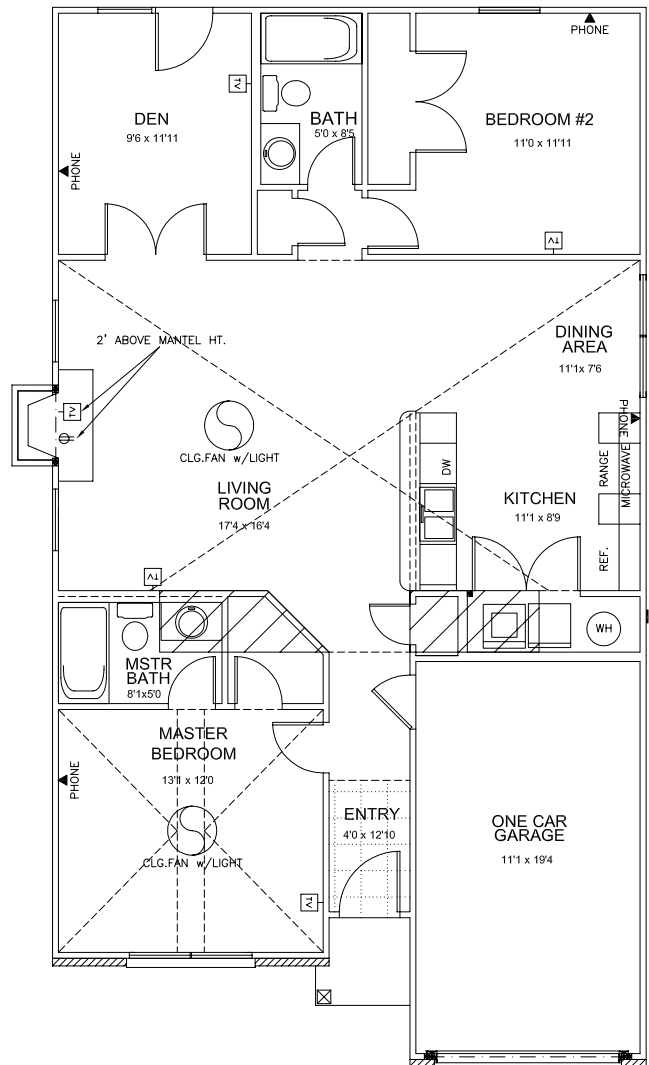

Right from start to finish
Ballhomes®

Because we are constantly working to improve our homes, prices and floorplans are subject to change without notice.

- Elevation B
- Outside chase fireplace with Cross Cut Travertine tumbled marble hearth and surround, Cambridge mantel, and black doors.
- Carpet: Avensong Classic 00161 Soft Leather with 8lb, ½" Ultimate carpet pad.
- Ceramic tile entry ACH76-12
- Vinyl flooring in master bath, utility room, hall bath, kitchen, and breakfast area: Initiator 66177
- Seacrest Dawn cabinets with Himalayan Slate 3689-58 countertop and full wall travertine backsplash, P024, 4X4
- Upgraded kitchen sink: 8" deep, stainless, Dayton DSE23322-4
- ADI black appliances include dishwasher, microwave, coil top range, and refrigerator with top freezer.
- Mushroom Cap wall paint with Antique White trim in all living areas where included in neighborhood; otherwise Antique White.
- Textured ceilings
- Ceiling fans with lights in master bedroom and family room (in lieu of track light in family room)
- Two additional cable outlets and a 110 outlet in family room over fireplace
- Garage door opener

- Windows: White
- Brick: Old Indiana Tudor. Alternate brick selection (if color already used on home next door): Homestead.
- Siding: White
- Garage door: White
- Roof: Moire Black (Architectural or 3-tab per neighborhood included features)
- Shutters: Raised panel black
- Front Door: Black